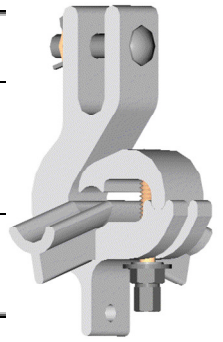

SIMBOLIZARE : CSALE 50 – 70 (95 – 120)
SYMBOL :
CSALE - Clemă de Susținere cu ALunecare tip Eximprod
 - *controlled slippage suspension clamp type EPG*
50-70 (95-120) - gama de secțiuni ale conductorului
 - *section range of steel - aluminium conductors (mm²)*

| Caracteristici tehnice <i>Technical Data</i> | UM <i>MU</i> | Tipul clemei <i>Clamp type</i> | |
|--|---------------------------------|-----------------------------------|--------------|
| | | CSALE 50-70 | CSALE 95-120 |
| Tensiunea nominală maximă a rețelei <i>Maximum system voltage (recommended)</i> | kV | 24 | |
| Sarcina mecanică <i>Mechanical load</i> | De exploatare <i>Working</i> | 10 | 15 |
| | Maximă <i>Maximum</i> | 20 | 30 |
| Sarcina de alunecare a conductorului <i>Conductor's slippage load</i> | daN | 150 | 200 |
| Masa / <i>Weight</i> | kg | 0,52 | 0,59 |